

Electrical position indicator

Construction

The GEMÜ type 1229 electrical position indicator with inductive sensor 3-wire technology and optical position indication has a stable water-proof plastic housing, a transparent cover (bayonet fixing) which enables good optical indication of the flow path and universal trigger cams. The removable mounting plate is either fitted with microswitches or inductive sensors (direct switching or acc. to NAMUR). Its height-adjustable feet can be turned inward or outward. It also has LED indication.

Features

- Easy setting of the trigger cams by means of the new setting system
- By rotating the feet 180° the microswitch can be used for VDI/VDE 3845 dimensions 80 mm and 130 mm
- Switch positions of straight through or 3 way valve bodies (T or L design) can be indicated

Advantages

- Using a single mount, the microswitch can be adjusted to fit all standard connections and mounting dimensions
- Corrosion-resistant housing

Dimensions GEMÜ 1229 (mm)

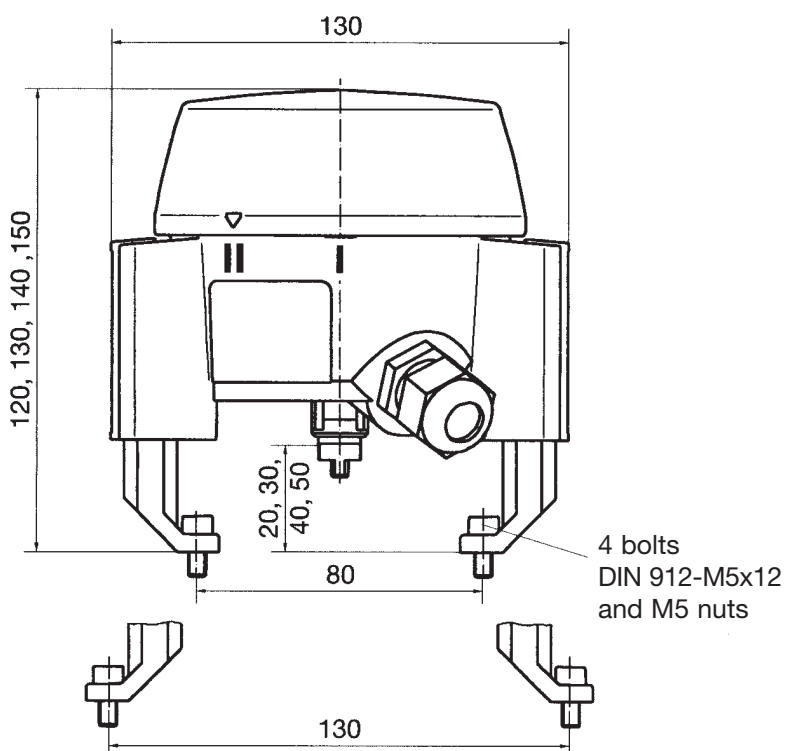

Technical specifications

Mounting dimensions

acc. to VDI/VDE 3845 for flange designs
30x80 and 30x130 (s. page 3)

Materials

Cover	Lexan 143 R
Switching shaft	POM
Seals	NBR
PG cable glands / counternut	PA
Other plastic parts	ABS, T45
Hexagon socket screw	A2-70

Indicator and switching range

Angle of rotation 0° ... 90°

Cable entry

Clamp range
(bushed) 5 - 10 mm

Recommended cross section of wire

Cable \varnothing 5-10 mm, max. 2.5 mm²

Voltage range

9 V - 36 V/DC

Admissible temperatures

-20° C ...+70° C

Continuous current

200 mA

Protection class

IP 67 DIN 40050, VDE 0470/EN 60529

Switching function

positive switching, PNP make contact
in end position damped or undamped

Order specifications

Function

Function	Ref. no.
OPEN/CLOSED	A00
OPEN	A01
CLOSED	A02

Electrical connection

Electrical connection	Ref. no.
PG 13.5	00
Other connections upon request	

Switch

Switch	Ref. no.
NBN4-V3-E2-Y51516 /P+F	01
IS 5064 IS-32, 5-BPOG /IFM	02

Order example

Order example	1229	000	Z	A00	01	00	
Type	1229						
		000					
Accessories			Z				
Function (ref. no.)				A00			
Switch (ref. no.)					01		
Electrical connection (ref. no.)						00	

Dimensions GEMÜ 1229 (mm)

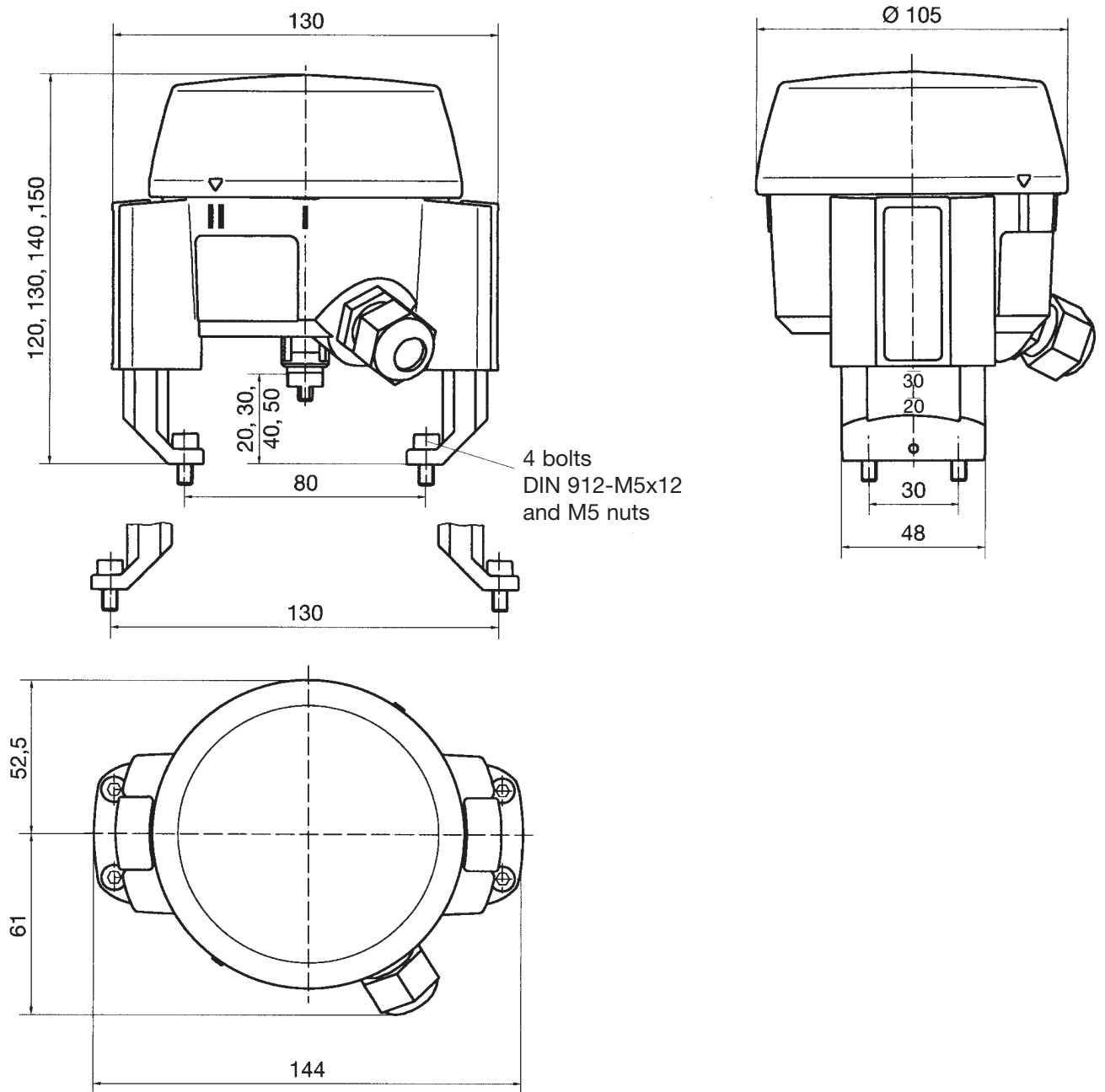

Connection diagram

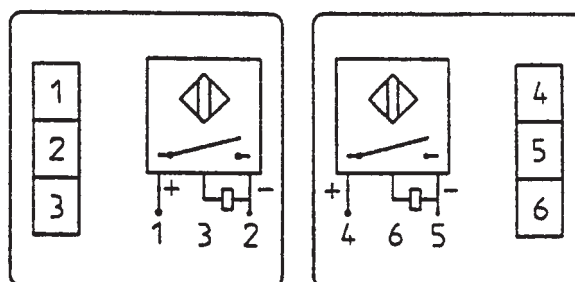

GEMÜ® VALVES, ACTUATORS
AND CONTROL SYSTEMS

